

GENERAL:

The P-Trap is a stainless steel accessory that can be used in areas of drainage to prevent sewer gas from entering a facility. It is recommended to be used with all FoodSafe Catch Basins, Area Drains, Hub Drains, and Floor Sink bottom/vertical outlets.

MATERIALS

- T304 Stainless Steel
- T316 Stainless Steel

INSTALLATION:

The FoodSafe P-Trap shall be installed in accordance with the manufacturer's installation instructions and recommendations.

TYPICAL PROFILE OF A P-TRAP

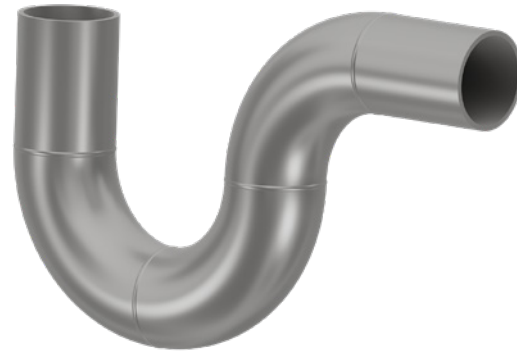
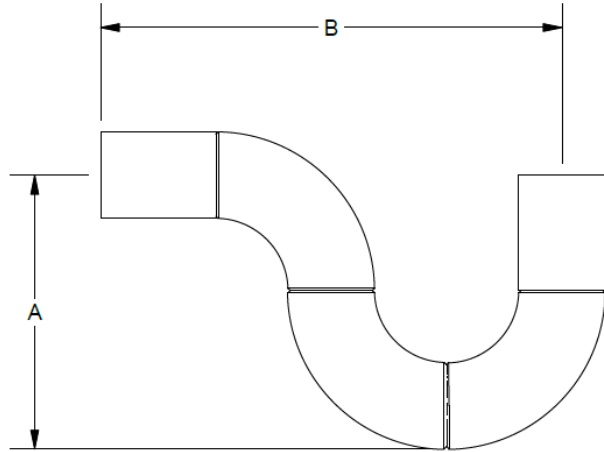

DRAIN CHANNELS DESCRIPTION	PART NUMBER	PIPE SCHEDULE	A (INCHES)	B (INCHES)
P-TRAP WITH 3" PIPE, SCHEDULE 10	PTRAP-53A	10	10.75	19.50
P-TRAP WITH 3" PIPE, SCHEDULE 40	PTRAP-53	40	10.75	19.50
P-TRAP WITH 4" PIPE, SCHEDULE 10	PTRAP-54A	10	14.25	24
P-TRAP WITH 4" PIPE, SCHEDULE 40	PTRAP-54	40	14.25	24
P-TRAP WITH 6" PIPE, SCHEDULE 10	PTRAP-56A	10	21.31	33
P-TRAP WITH 6" PIPE, SCHEDULE 40	PTRAP-56	40	21.31	33
P-TRAP WITH 8" PIPE, SCHEDULE 10	PTRAP-58A	10	28.31	42
P-TRAP WITH 8" PIPE, SCHEDULE 40	PTRAP-58	40	28.31	42
P-TRAP WITH 10" PIPE, SCHEDULE 10	PTRAP-510A	10	35.37	51
P-TRAP WITH 10" PIPE, SCHEDULE 40	PTRAP-510	40	35.37	51
P-TRAP WITH 12" PIPE, SCHEDULE 10	PTRAP-512A	10	42.37	60
P-TRAP WITH 12" PIPE, SCHEDULE 40	PTRAP-512	40	42.37	60

Specifying engineer is responsible for concrete encasement and reinforcing based upon application and local codes. FoodSafe Drains reserves the right to change the product and specifications without notice.