

NOTES: UNLESS OTHERWISE SPECIFIED

1. ALL DIMENSIONS ARE IN INCHES.
2. DRAIN BODY MATERIAL: 16GA STAINLESS STEEL T304/T316
3. SPECIFYING ENGINEER IS RESPONSIBLE FOR CONCRETE ENCASEMENT AND REINFORCING BASED UPON APPLICATION AND LOCAL CODES.
4. REFER TO <https://info.slotdrainsystems.com/installresources> FOR INSTALLATION INSTRUCTIONS.

| REVISIONS | | | |
|-----------|---------------------------------------|-----------|----|
| REV | DESCRIPTION | DATE | BY |
| 0 | INITIAL RELEASE - RO | 4/26/2019 | DK |
| 1 | UPDATED THE LEVELER & WALL CONNECTION | 3/19/2020 | DK |
| 2 | UPDATED THE DRAIN LAYOUT | 7/14/2021 | DK |
| 3 | REMOVED LEVELER & REBAR CONNECTIONS | 9/1/2023 | DK |
| 4 | UPDATED WITH GLOBAL DRAIN TEMPLATE | 2/14/2024 | DK |

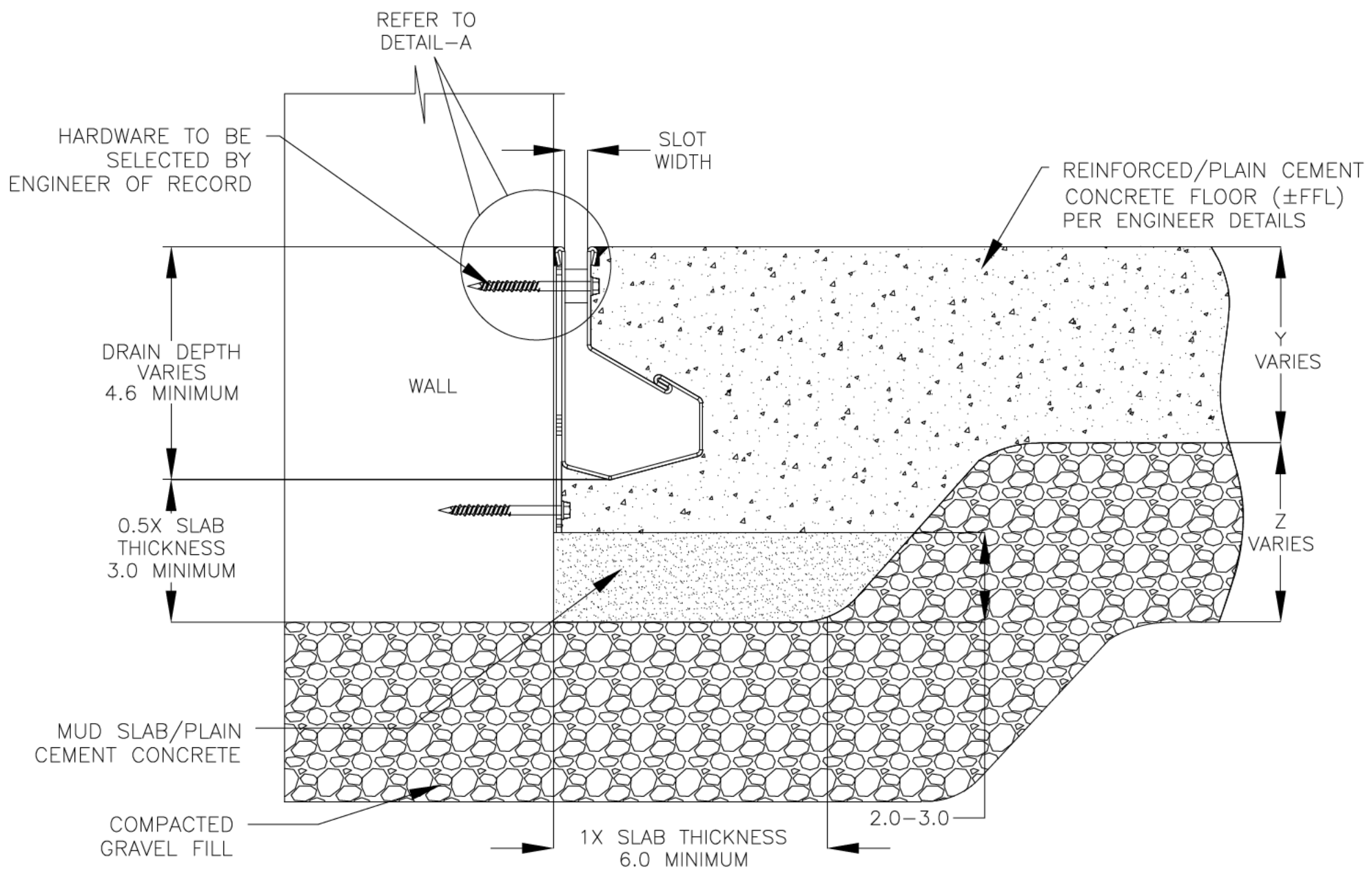

4000 SERIES SLOT DRAIN WALL INSTALLATION DETAILS

REINFORCED/PLAIN CEMENT CONCRETE SLAB (±FFL) PER ENGINEER DETAILS

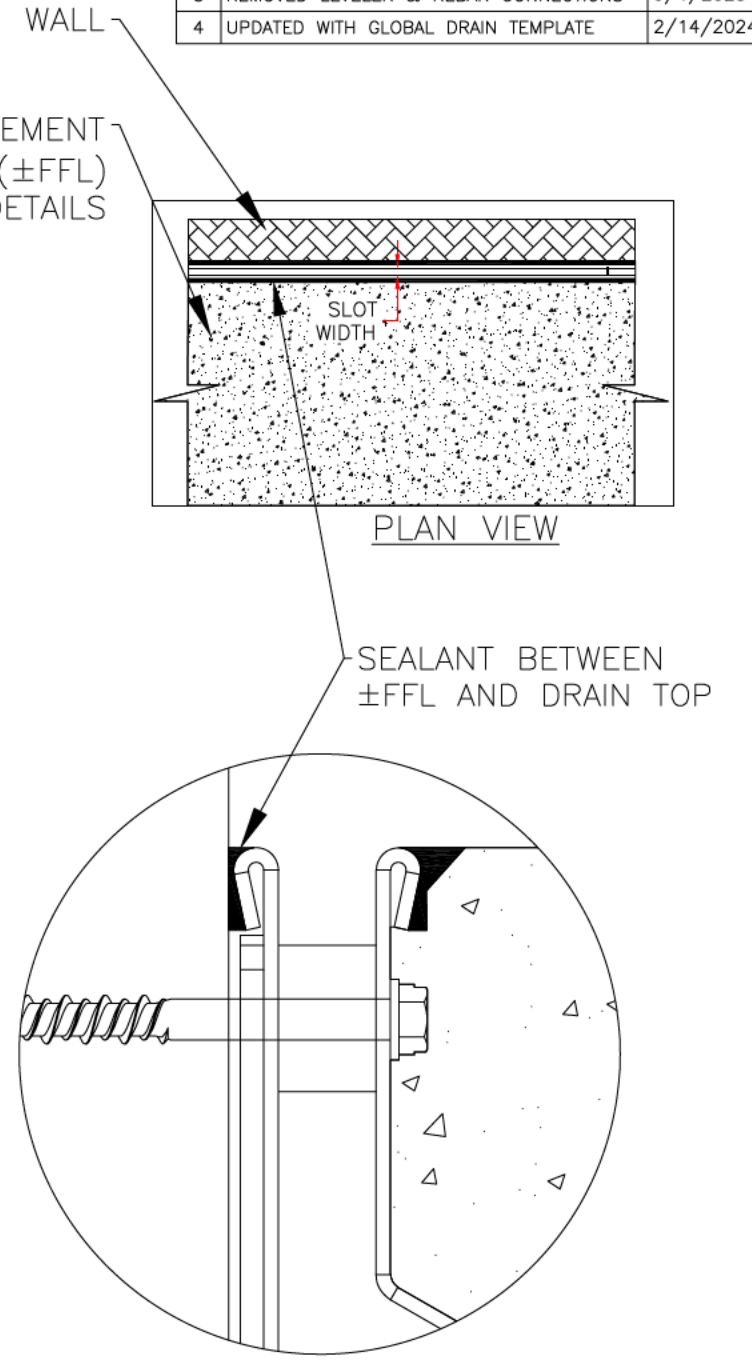

DETAIL-A



DRAWING TITLE
CONCRETE FLOOR-NEW CONSTRUCTION WALL INSTALLATION

DRAIN SERIES
4000 SERIES SLOT DRAIN

DWG NO. IN-SD4000-002-R4 SIZE B SCALE NTS SHEET 1 OF 1

ALL DRAWINGS ARE THE EXCLUSIVE PROPERTY OF SLOT DRAIN SYSTEMS. ANY REPRODUCTION IN PART OR IN WHOLE IS PROHIBITED WITHOUT PROPER CONSENT.

REV. 4